

# Jukes & Co

## Estate Agents



## Cuthbert Gardens

, London, SE25 6SS

£300,000



Presenting an exceptional opportunity, this beautifully maintained one bedroom freehold house is situated in a tranquil cul-de-sac, conveniently located just a short walk to Norwood Junction station. Residents will appreciate the proximity to a variety of local amenities, as well as the picturesque South Norwood Lake & Grounds, which offer a serene escape from urban life.

The property features a spacious reception room, cleverly designed to accommodate both relaxation and dining areas, complemented by a beautiful open plan modern kitchen and allocated parking

This charming home also provides ample storage solutions in the primary bedroom, ensuring that space is utilized efficiently. The well-appointed shower room adds to the overall appeal of the property, catering to both comfort and functionality.

Additionally, the delightful, secluded garden serves as an ideal retreat for outdoor relaxation, particularly during the warm summer months, allowing residents to fully enjoy their surroundings.

This home not only offers a perfect blend of style and practicality but also embodies a lifestyle of convenience and tranquility, making it a truly desirable place to live.



## Area Map

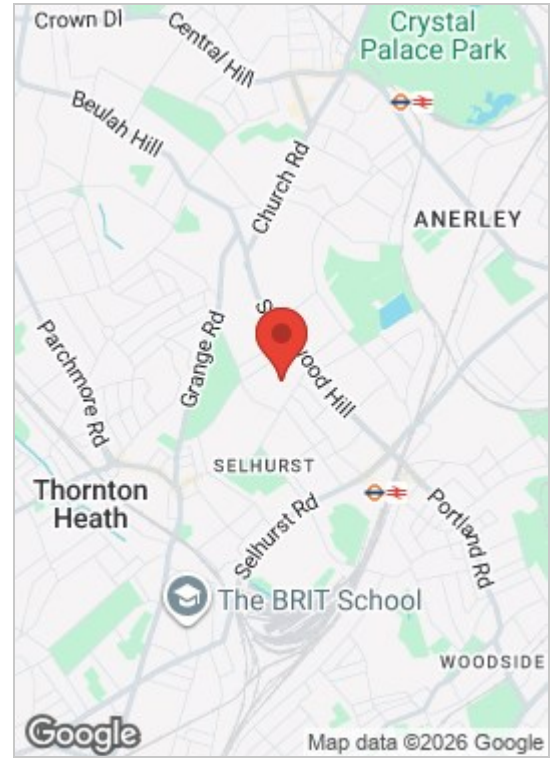

## Floor Plan

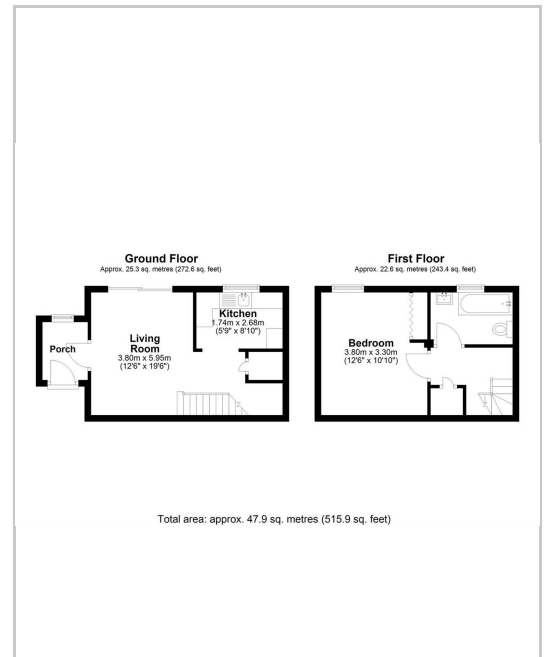

## Energy Efficiency Graph

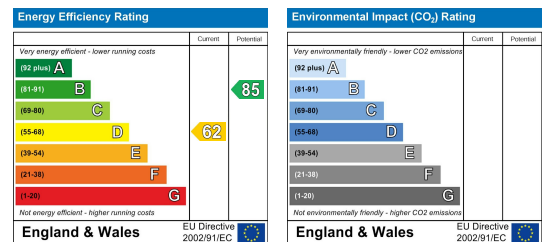

These particulars, whilst believed to be accurate are set out as a general outline only for guidance and do not constitute any part of an offer or contract. Intending purchasers should not rely on them as statements of representation of fact, but must satisfy themselves by inspection or otherwise as to their accuracy. No person in this firm's employment has the authority to make or give any representation or warranty in respect of the property.

### Sales and Lettings

76 High Street, South Norwood, London SE25 6EB

T: 020 8653 9393 · F: 020 8771 5551 · E: sales@jukesestateagents.com · E: lettings@jukesestateagents.com

W: jukesestateagents.com